

SERIES 851 SLOTTED LINEAR



OVERLAY/LIGHT CONTROL FILM BY OTHERS



SUSPENSION OPTIONS BY OTHERS

AVAILABLE WITH EITHER SPADE OR BULL NOSE END CAPS

Y-CABLE

SINGLE CABLE

SPADE

BULL NOSE

Application

- Indirect/Direct lighting fixture.
- The direct lighting component will be through the slots with either an opaque overlay (by others) or by louvers. Louvers give a better than 45 degree cut off to the lamp. Louvers are available in white or semi-specular finish.
- Luminaires are designed to be used with 1, 2 or 3 T5 or T5HO nominal four foot lamps.

Finishes

- Unpainted/unfinished roll formed steel housing with slotted openings. Customer to source local powder coating facilities for housing and die cast aluminum end caps. Internal ballast bracket assembly produced using precoated white steel. It is shipped as an assembly with lamp holder brackets and adjustable ballast brackets attached.

Reflectors:

- Enhanced aluminum for indirect lighting component and slotted for direct component.

Features

- Units are shipped with die cast aluminum joiners installed for suspension and structural continuity.
- Designed to mount on exact 4 foot and 8 foot centers. Joiners will accept stems, single cable, "V" cable and power cords as supplied by lighting fixture manufacturer.
- Architectural ends. There are two die cast aluminum designs available, "spade" and "bullnose" configurations. They are bolted to the die cast joiners for a complete architectural look.
- Series 851 is the matching suspended luminaire to the Series 856 Linear Wall Mount Slotted.

Optional Features

- Please contact factory for any optional features.

Custom modifications in the physical specification are available for this fixture.

Lamping Options

T5	T5HO
(1-3) 28W (4')	(1-3) 54W (4')
(2-6) 28W (8')	(2-6) 54W (8')

Packaging

Bodies per skid	4'	8'
	TBD	TBD



SERIES 851 SLOTTED LINEAR

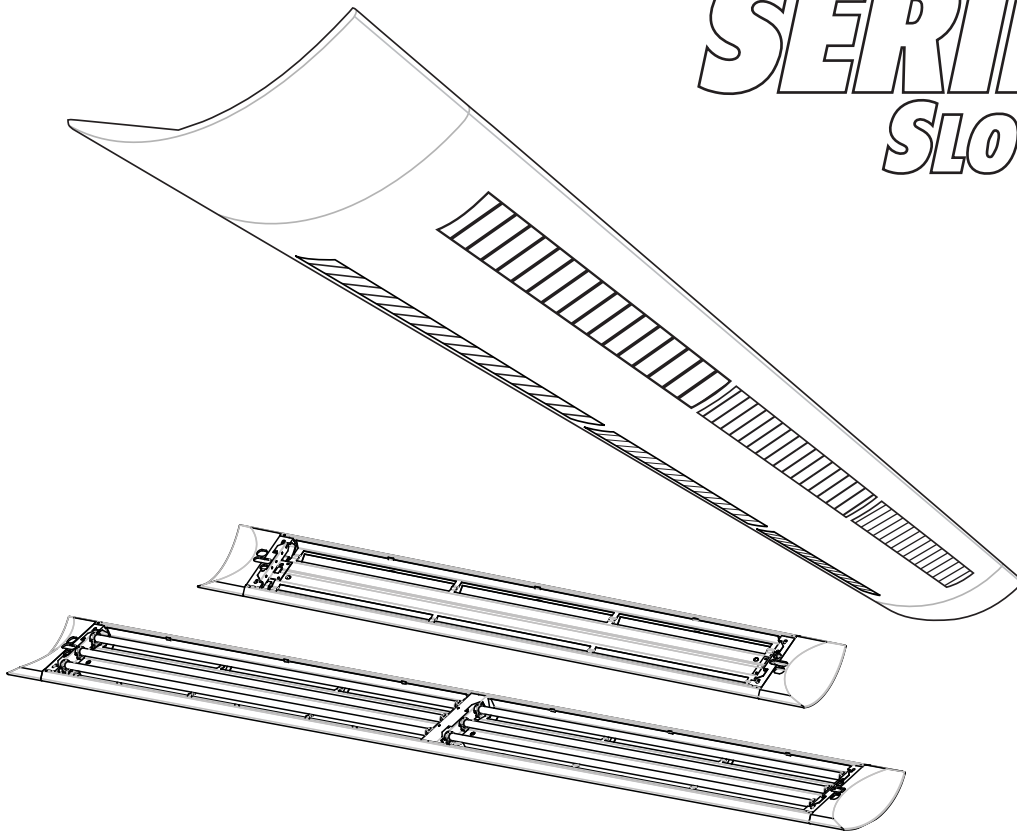

AVAILABLE WITH
EITHER SPADE OR
BULL NOSE
END CAPS

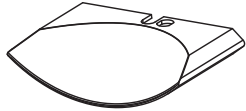

SPADE

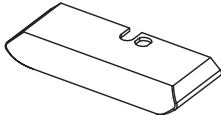

BULL NOSE

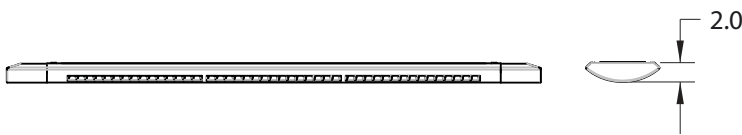
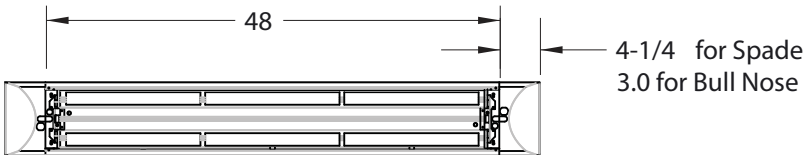

T5	
SIZE	LENGTH
(1 to 3) 28W	48
(2 to 6) 28W	96

T5HO	
SIZE	LENGTH
(1 to 3) 54W	48
(2 to 6) 54W	96

Add 3" for each Bull Nose end cap
Add 4-1/4" for each Spade end cap

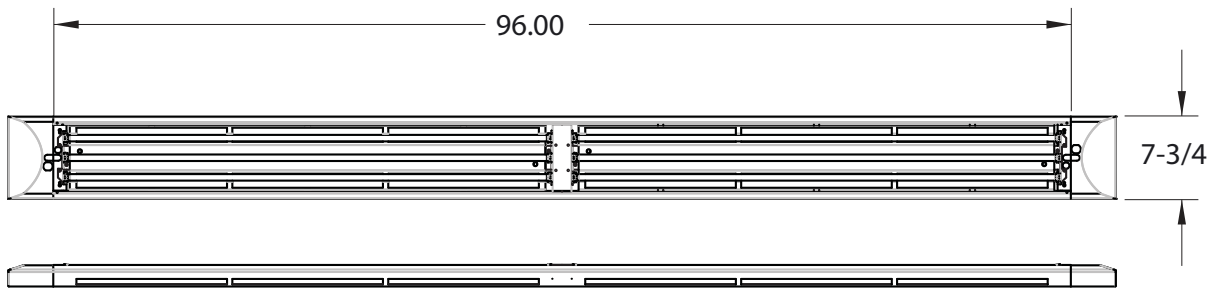
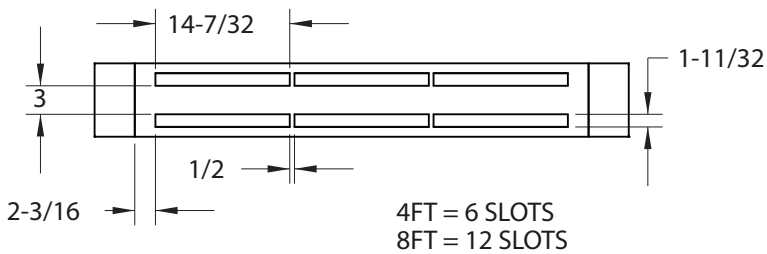

REV 7-24-09



PAINING PROCEDURES FOR SUSPENDED & WALL MOUNT LINEAR FIXTURES

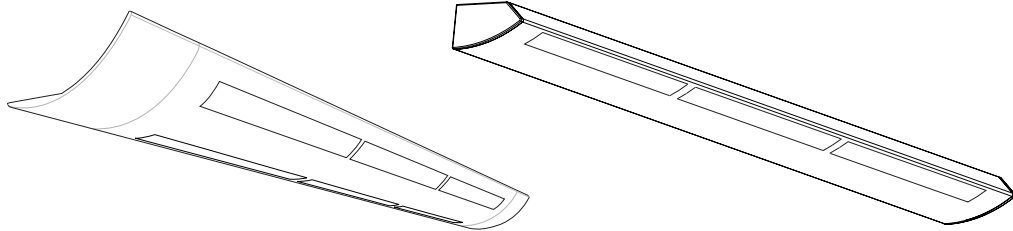

SEND THESE PROCEDURES WITH FIXTURES TO THE PAINTER

PROCEDURES:

1. Make sure end caps are mounted to the body before painting.
2. If no end caps are needed, make sure you mask off the outside face of the joiner before painting. This will assure a good fit between joiners.
3. Make sure the painter is aware that the body is steel and the end cap and joiner are aluminum cast.
4. The painter should check the gap between the end cap and joiner to make sure there is a good fit and that there are no gaps before painting. Close gaps by pushing the end cap towards the body.



4 FT ASSEMBLY

HARDWARE LIST (by other)

- (A) 8-32 X 1/4" Long Self Tapping Screw (4 Pcs.)
"Do not replace with SHEETMETAL SCREWS"
- (B) 1/4-20 X 1 3/4" Long Hex Head (4 Pcs.)
- (C) 1/4 TURN FASTENER (2 Pcs.) / Supplied

ASSEMBLY INSTRUCTIONS

- 1.) Mount End Caps to Body with (B).
- 2.) Install Ballast Assembly with (A).
- 3.) Install Reflector with (C)
- 4.) Peel off protective coating on reflector.

NOTE:

If running continuous string of bodies, connect bodies together with (B) to each Joiner. At the end of run mount End Cap. Make sure each Joiner has a suspension system.

All suspension systems to be supplied by others.

Warning:

Each Joiner must have a suspension system.

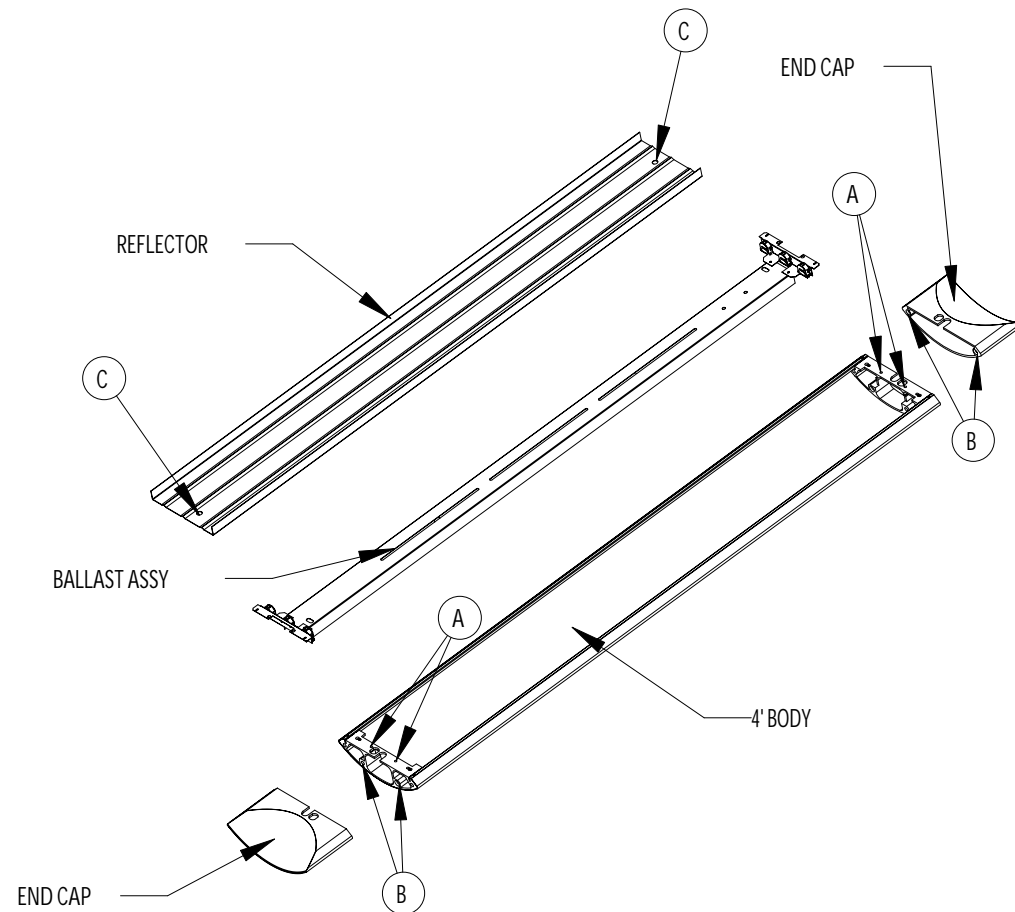

NOTE:

When attaching the Bodies together use the bottom holes on the Joiner.





HARDWARE LIST (by other)

- (A) 8-32 X 1/4" Long Self Tapping Screw (4 Pcs.)
- (B) 1/4-20 X 1 3/4" Long Hex Head (4 Pcs.)
- (C) 8-32 X 1/4" Long Sheetmetal Screw (4 Pcs.)
- (D) 1/4 Turn Fastener (4 Pcs.) / Supplied

8 FT ASSEMBLY

ASSEMBLY INSTRUCTIONS

- 1.) Mount End Caps to Body with (B).
- 2.) Insert Center Plate in the Body. (Snaps in place)
- 3.) Install Ballast Assemblies with (A)
- "DO NOT USE SHEET METAL SCREWS"
- 4.) Install Reflector with (D).
- 5.) Peel off protective coating on reflector.

NOTE:

If running continuous string of bodies, connect bodies together with (B) to each Joiner. At the end of run mount End Cap. Make sure each Joiner has a suspension system.

All suspension systems to be supplied by others.

Warning:

Each Joiner must have a suspension system.

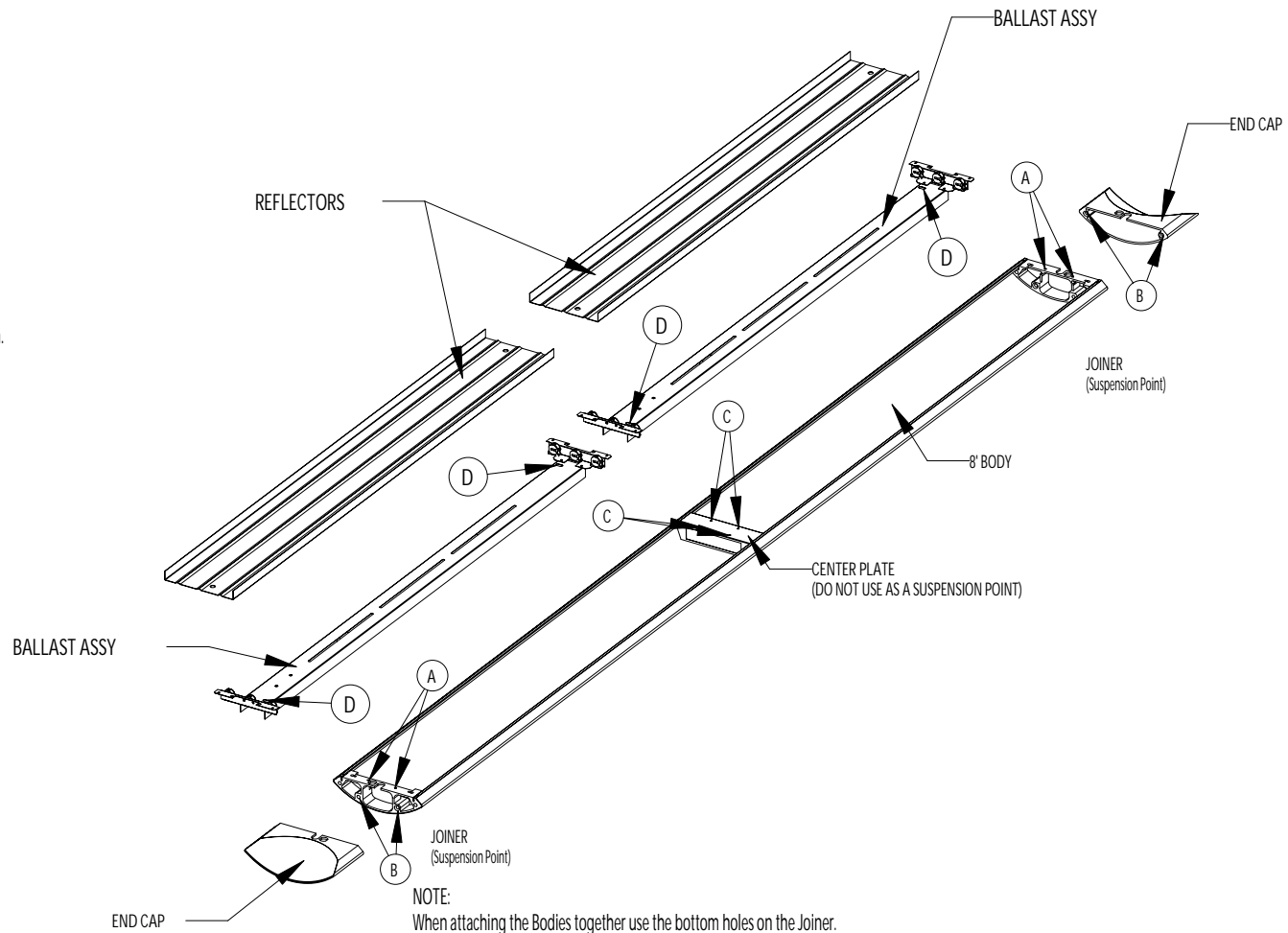

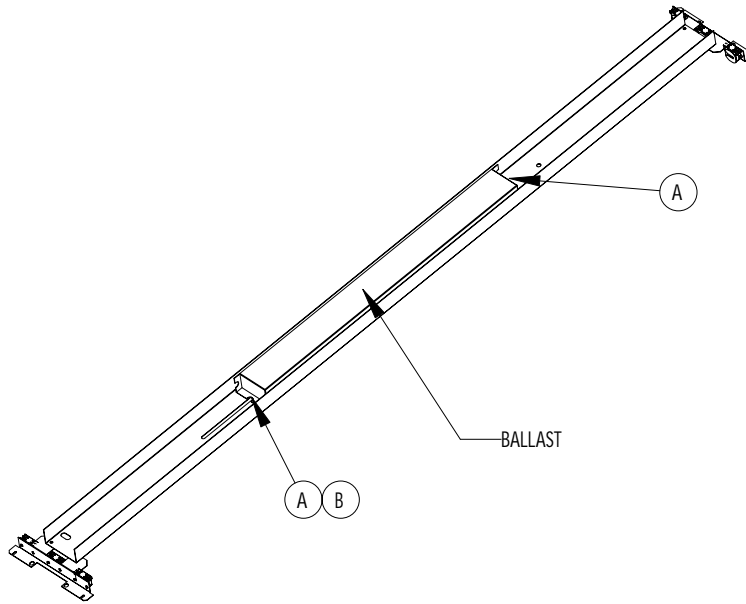

BALLAST ASSEMBLY

ASSEMBLY INSTRUCTIONS

- 1.) Attach Ballast to the 8-32 Stud provided in the Wire Trough with 8-32 Lock Nut.
- 2.) Attach other end of Ballast to the slot provided in the Wire Trough with 8-32 Screw & Lock Nut.
- 3.) Snap in Lamp Holders to the bracket, use standard at one end and spring back at the other end.

HARDWARE LIST (by other)
(A) 8-32 Capped Washer Type Lock Nut (3 PCS)
(Palnut Company Cat.# DO832075)
(B) 8-32 X 3/8" Long Screw

RECOMMENDED SOCKETS

(3 Pcs - 600V Rotary G5)
Vossloh Schwabe - 108663
Stucchi - 285/FAU
BJB - 26.641.2001.50
ALP - LH-150-28

(3 Pcs - 600V Rotary G5 Spring)
Vossloh Schwabe - 108664
Stucchi - 285/MAU
BJB - 26.641.2007.50
ALP - LH-150-28S

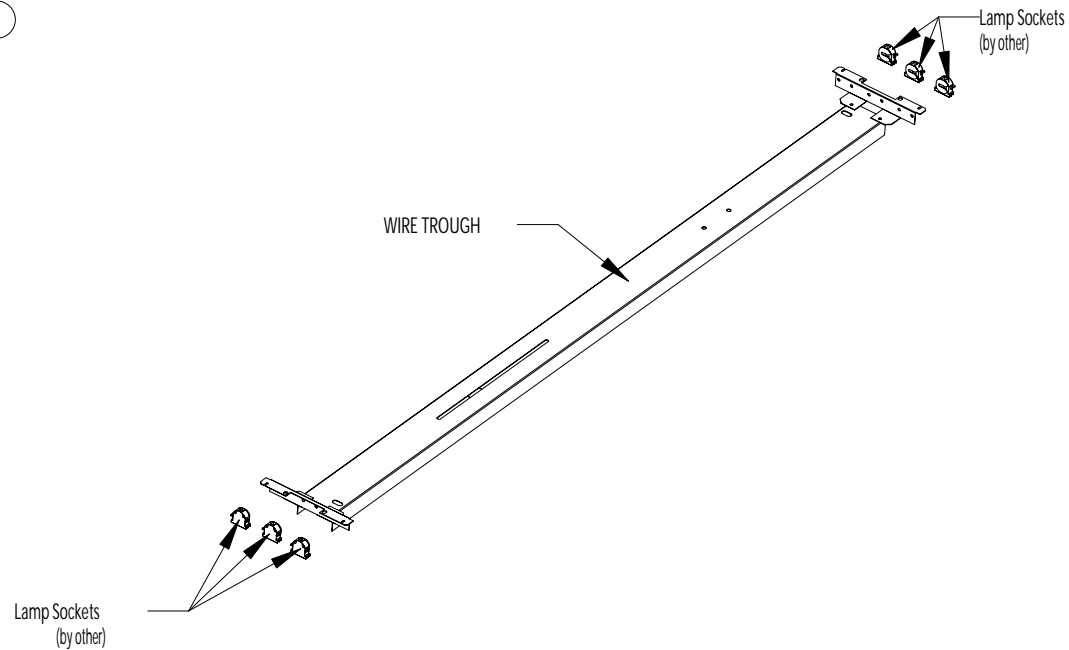



LOUVER/CLIP ASSEMBLY INSTRUCTIONS

1. Assemble and wire fixture as per instructions.
2. Make sure Ballast Bracket is in place first. Place Louver Assembly into slots from the inside of the Linear Body.
3. Position clip in the middle of the Louver assembly, seated against the pinch point near the Louver assembly. See diagram.
4. Once clip is into position push down and snap into place.

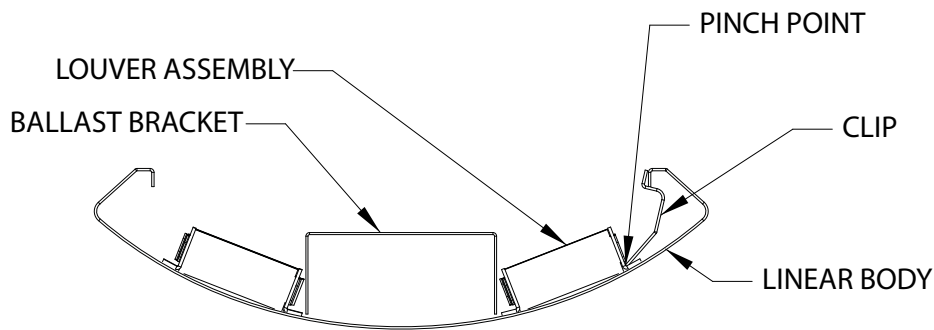
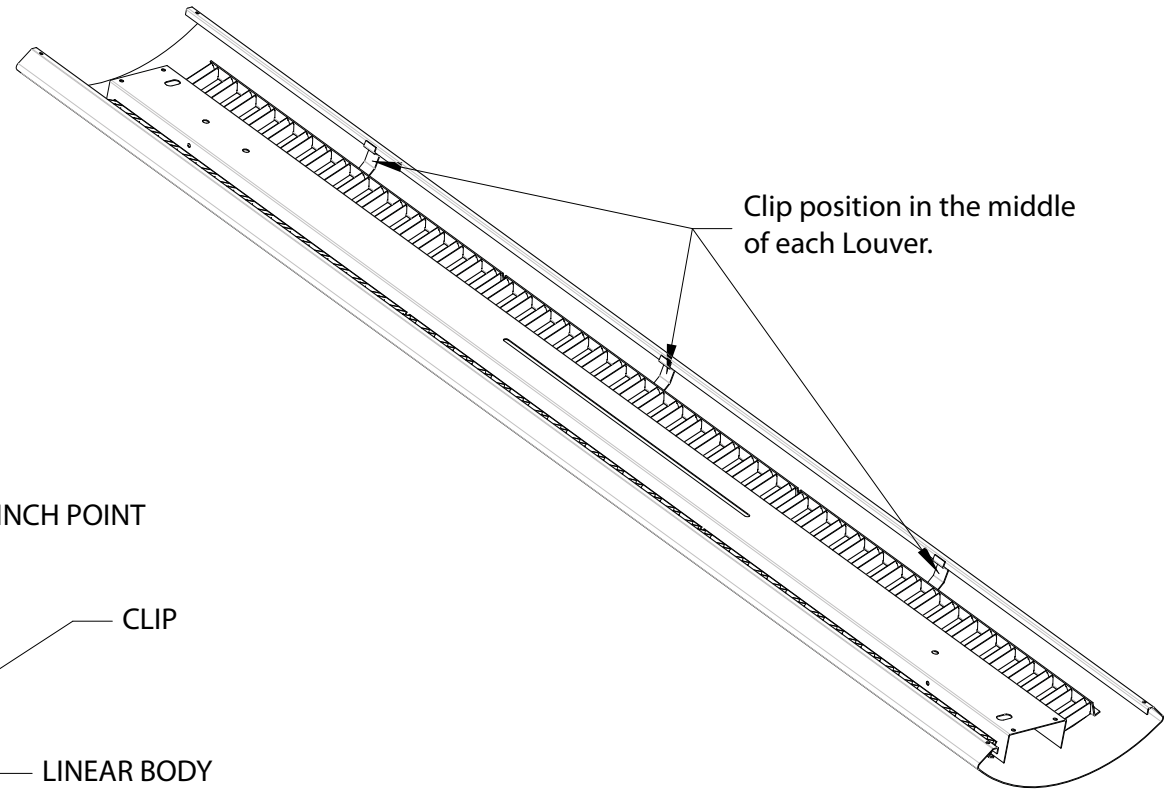

CROSS SECTION

