

SERIES 814

HIGH BAY EXPRESS



SIX LAMP



WIRE GUARD



Application

- Low bay/high bay warehouses/manufacturing facilities
- Sport facilities and multifunction rooms
- Big box stores and retail facilities
- Luminaire designed for higher ambient heat applications with air flow around lamps and ballast compartment.

Finishes Available

Frame:

- Standard in white CRS

Reflectors:

- Enhanced aluminum for direct lighting component and slotted for indirect component.

LAMPING OPTIONS

T5HO	T8
(4) 54W (6) 54W*	(4) 32W (6) 32W*

* 2 additional socket knockouts for 6 lamps are standard with additional center reflector optional.

Features

- Ceiling mounted or suspended with cables, stems, hooks or chains by others.
- Reflectors available with 10% up-light or 100% down-light.
- Two 2-lamp computer designed individual reflectors.
- Standard frame accommodates 4 T5HO or T-8 lamps with knockouts for six lamps.
- Additional 2-lamp reflector for 6 lamps optional.
- Space available for 4 ballasts, motion sensors and remote control switching.
- Snap-on ballast cover with optional single screw fastening.
- Access panel standard for easy wiring without opening ballast compartment.

Optional Features

- Optional 11-gauge wire guard.
- Luminaire can be differentiated to accommodate your design objectives.
- Luminaire is "LED READY" for Intematix's Tubulight. Check with factory for catalog numbers.

PACKAGING

BODIES w/REFLECTORS	2
------------------------	---

Contact us for information on custom modifications including size, color and accommodations for a variety of motion and/or sound detectors, night lights and LED arrays.

Specifications subject to change without notice.



Adam Metal Products Company • P.O. Box 450 • Ledgewood, NJ • 07852
Phone: 973.770.1100 • Fax: 973.770.1105 • www.adammetal.com



SERIES 814

HIGH BAY EXPRESS

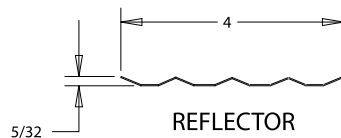
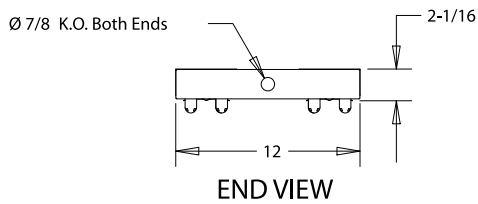
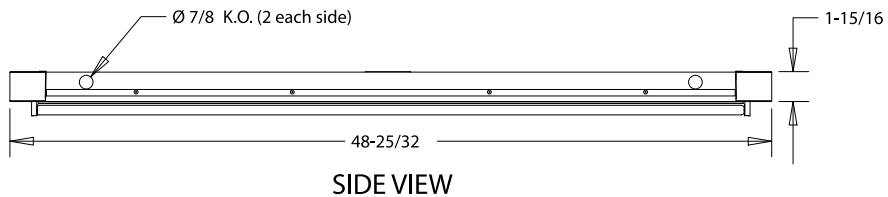
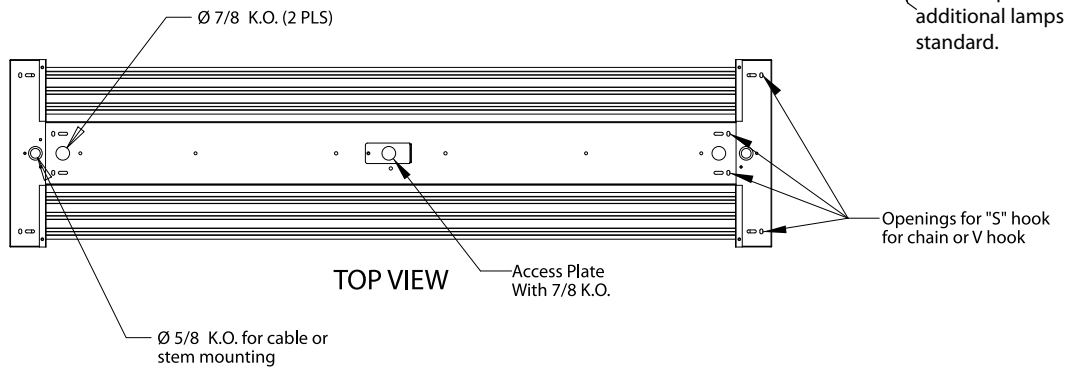
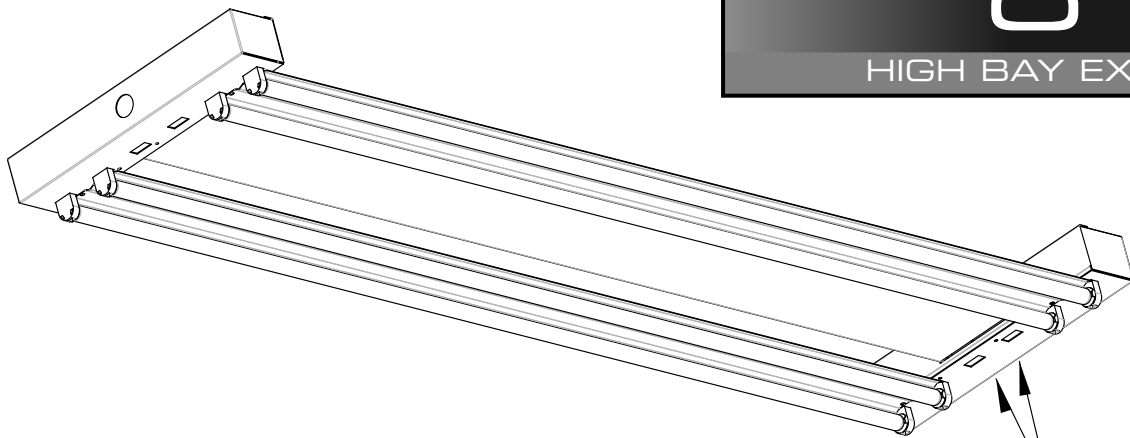

Lamping Options

T5HO	T8
(4) 54W (6) 54W*	(4) 32W (6) 32W*

* 2 additional socket knockouts for 6 lamps are standard with additional center reflector optional.

Visit our website www.adammetal.com for photometrics and assembly instructions.

Specifications subject to change without notice.

REV 4-26-10

MADE IN THE
USA

Adam Metal Products Company • P.O. Box 450 • Ledgewood, NJ • 07852
Phone: 973.770.1100 • Fax: 973.770.1105 • www.adammetal.com

